

HDM2

Molded case circuit breaker

User Manual

Standard: IEC 60947-2

□ Please read the User Manual carefully before installing and using the Product, and keep it properly for further reference.



Security Statement

Please read the User Manual carefully prior to installation, operation, maintenance and inspection, and install and use the Product correctly by the Manual.

Hazard:

- It is forbidden to touch the circuit breaker with wet hands;
- Do not touch any moving part during operation;
- Cut off power supply during maintenance.

Note:

- Installation, maintenance and repairing should be undertaken by professional technicians;
- Product characteristics have been set during delivery, do not adjust them randomly in use
- Confirm whether the product voltage, current, frequency and use type conform to the requirements prior to use;
- The bare wire or copper wire of terminal should be insulated to prevent interphase short circuit;
- The electronic parts between current circuits should be disconnected, in order to test the insulation resistance, power frequency and withstand voltage, and prevent weakening the product performance;
- For any damage or abnormal sound when dismantling the product, stop using it immediately and contact the supplier;
- Handle the product wastes as industrial waste. Thank you for your cooperation.

Type HDM2-125 Molded Case Circuit Breaker

● Packing List

No.	Item	Unit
1	Circuit breaker	
2	Binding screw	
3	Mounting screw	
4	User Manual	
5	Interphase baffle	

HDM2-125 product

● Introduction

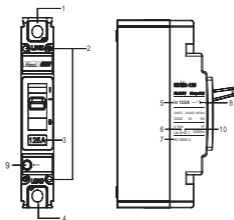

HDM2-125/1P

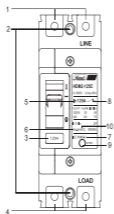

HDM2-125/2P

Note:

- | | |
|------------------------|--------------------------|
| 1.Power end | 2.Mounting holes |
| 3.Rated current | 4.Load terminal |
| 5.Technical data | 6.Use category |
| 7.Applicable standards | 8.Isolation symbol |
| 9.Trip push button | 10.Reference temperature |

Normal use and installation conditions

● Normal use conditions:

- 1) The ambient temperature is -30°C ~ 70°C and the 24h mean value does not exceed $+35^{\circ}\text{C}$;
- 2) Altitude: $\leq 2000\text{m}$;
- 3) When the max. ambient temperature is $+50^{\circ}\text{C}$, the atmospheric relative humidity should not exceed 50%; higher humidity is allowed at lower temperature, for example, the humidity can reach 90% at $+20^{\circ}\text{C}$; preventive measures should be taken against the accidental condensation due to temperature changes;
- 4) Use it in the medium without explosion hazards, and it should be free from gas or conductive dust which may corrode metal and damage the insulation.

● Normal installation conditions:

- 1) IP grade: IP20 (except for wiring screws);
- 2) It should not be exposed to rain and snow, the tilting at all directions should not exceed 5° ;
- 3) It should be installed in places free from impact and vibration;
- 4) Connect the upper end to power supply and lower end to load;
- 5) Pollution grade: Grade 3;

● Normal storage and transport:

- 1) The temperature range should be from -25°C to $+55^{\circ}\text{C}$;
- 2) The relative humidity should not exceed 95% when ambient temperature is $+25^{\circ}\text{C}$;
- 3) Avoid strong impact and vibration during transport, carry it with caution and do not put it upside down.

Operation and test

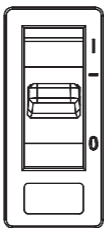

TRIP

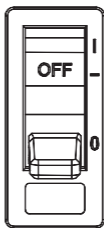

OFF

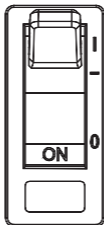

ON

Installation of HDM2-125

- Installation method

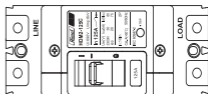

HDM2-125/1P

HDM2-125/2P

Vertical or horizontal installation

● Terminal dimensions (mm)

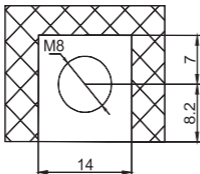

● Overall dimensions (mm)

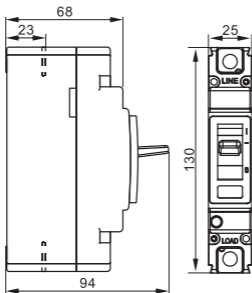

HDM2-125/1P

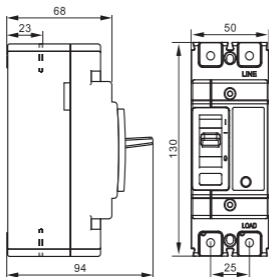

HDM2-125/2P

● Bottom installation dimensions (mm)

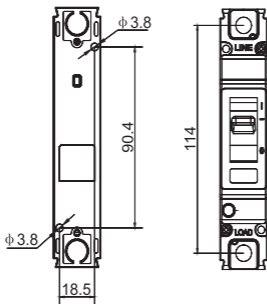

HDM2-125/1P

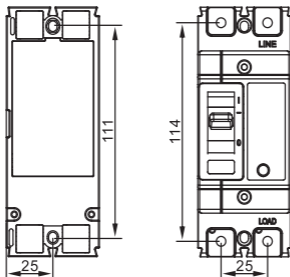

HDM2-125/2P

Pre-installation Precautions of HDM2-125

● Before installation:

- (1) Check if the parameters on nameplate conform to the operation requirements
- (2) Fix the handle at the button position;
- (3) Close/open the circuit breaker for 3 times and it should have reliable operation and no clamping, the handle is at "OFF" position;

● During installation:

- (1) Check if wiring is correct, connect the "LINE" to power supply, and connect "LOAD" to the equipment;
- (2) Refer to Table 1 below for the recommended sectional section of wiring and related current, to ensure normal functioning of circuit breaker;
- (3) Refer to Table 2 for the wiring fastening torque.

Table 1 Rated Current and Cross-section of Related Wiring

Rated current A	10	16/20	25	32	40/50	63	80	100	125
Conductor sectional section mm ²	1.5	2.5	4	6	10	16	25	35	50

Table 2 Tightening Torque

Specification of circuit breaker	Dimensions of binding screws	Fastening torque N·m
125AF	M8	9.5-10.5

Maintenance of HDM2-125

Maintenance must be carried out by professional personnel. Make sure to cut off power supply prior to maintenance and carry out one maintenance of circuit breaker when it has normal running. Refer to Table 3 for the details.

Table 3 Maintenance

Type	Item	Content
Circuit breaker	Appearance	Be free from dust and condensation. Carry out cleaning if necessary
		No damage
		The shell and link terminal should be free from color change
	Connection terminal	Conduct tightening according to the torque of Table 2, and it should not be loose
	Open/close the handle	The operation should be flexible
	Trip push button	The handle indicates the trip position after tripping of product
	Insulation test	Carry out test according to the product test requirements in the homepage

Standard accessories and necessary tools

Standard accessories

Tools	Dimensions	Qty.	Diagram
Mounting screw	M3X65	2	

Necessary tools

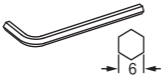
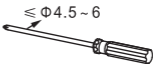
Hex wrench	Screwdriver
<p>mm</p> 	<p>mm</p> 

HIMEL

www.himel-electric.com

Copyright@himel-electric Co.,Ltd.  Paper can be recycled

Sep. 2024